

SIGNATURE

NORTH EAST

OFFICIALLY RATED THE NO.1 ESTATE AGENT IN THE NORTH EAST





📍 Patton Way, Morpeth NE61 6RZ

Patton Way, Morpeth NE61 6RZ

Asking Price
£145,000

Signature North East are delighted to welcome to the market this newly refurbished three bedroom semi-detached property, ideally located in Pegswood, near Morpeth. Set within a peaceful location close to green spaces, the home offers an ideal balance of tranquillity and convenience. Local amenities are just a short walk away, and Pegswood station is nearby, providing excellent transport links for commuting and easy access to surrounding towns and Newcastle City Centre.

Upon entering, you are welcomed into the central hallway, which also provides access to a convenient ground floor W.C. The first step leads you into the large living room, offering ample space for your desired furnishings. A large window allows natural light to flood the room, while a bright feature wall adds a modern feel to the space. The kitchen offers a plethora of storage through wall and base units, complemented by generous countertop space. From here, you can access the rear garden.

Continuing your journey to the first floor, you will discover three bedrooms. Bedrooms one and two can comfortably accommodate a double bed along with additional furnishings, while bedroom three is well suited to a single bed and further furnishings. Completing this floor is the bathroom, featuring a shower, hand basin and W.C.

Externally, this home offers a garden mainly laid to lawn, providing an ideal space to relax or entertain. On-street parking is available at the front of the property, adding further convenience for residents and visitors alike.



PLEASE NOTE THAT THE VENDOR HAS CERTIFIED THE PROPERTY INFORMATION AND IMAGES.

PROPERTY FLOORPLAN

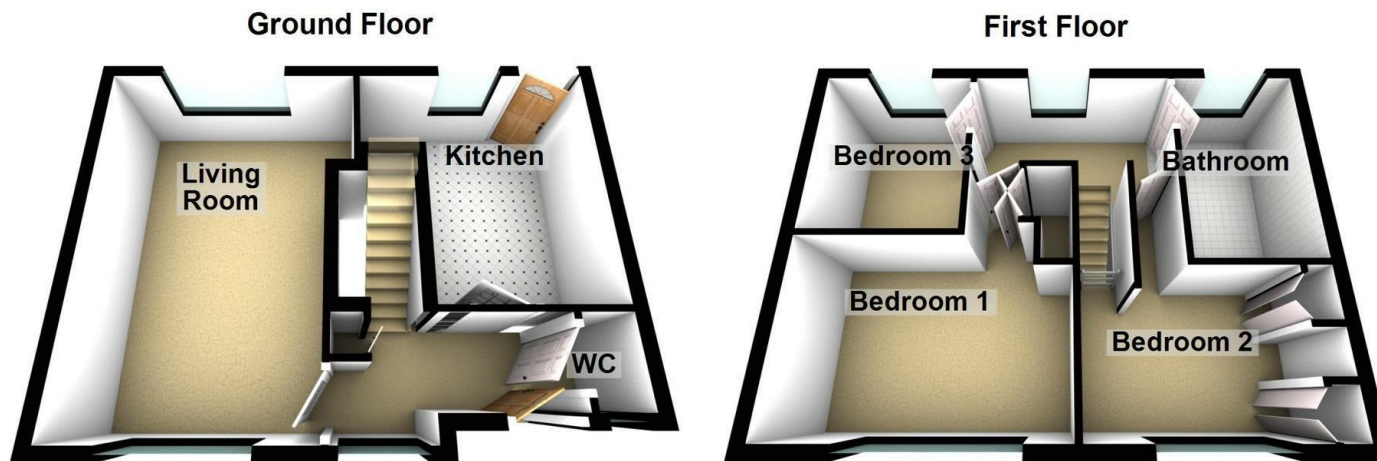

Total area: approx. 73.7 sq. metres (793.7 sq. feet)

Measurements:

Living Room
17'8" x 6'6"

Kitchen
11'3" x 8'3"

WC
3'6" x 2'7"

Bedroom One
8'9" x 12'8"

Bedroom Two
9'9" x 6'2"

Bedroom Three
8'9" x 7'5"

Bathroom
9'10" x 5'0"

Energy Efficiency Rating

	Current	Potential
Very energy efficient - lower running costs		
(92 plus) A		
(81-91) B		83
(69-80) C	69	
(55-68) D		
(39-54) E		
(21-38) F		
(1-20) G		
Not energy efficient - higher running costs		
England & Wales EU Directive 2002/91/EC 		





More 5 Star Customer Reviews than any other Agent based in the North East on allAgents.co.uk



SALES

LETTINGS

FINANCE

LAW

WE COVER THE WHOLE OF THE NORTH EAST

Whitley Bay
0191 251 3344

Cramlington
01670 897 213

Tynemouth
0191 296 6689

Morpeth
01670 513 966

Ponteland
01661 820 082

Wallsend
0191 432 4151

Alnwick
01665 511 800

Heaton
0191 432 4275

Forest Hall
0191 266 9966

Other locations
0191 640 3523

Newcastle
0191 640 2284

Durham
0191 303 8252

Gosforth
0191 640 3523

Sunderland
0191 543 6390

Whickham
0191 432 5102

Gateshead
0191 432 4294

Jesmond
0191 281 1037

Killingworth
0191 640 3602

Ryton
0191 413 9845

Head Office &
Lettings
0191 253 4815

*Highest recommended 5-star reviews than any other Estate Agent based in the North East on allAgents.co.uk - The UK's Largest Customer Review Website for the Property Industry & Awarded Best Estate Agency 2018 & 2019 - North East England by SME News